



MOVE INN ESTATES

MAKING THE RIGHT MOVE



The Vale

, Hounslow, TW5 9HS

Offers In The Region Of £600,000



3



1



1



Floor Plan

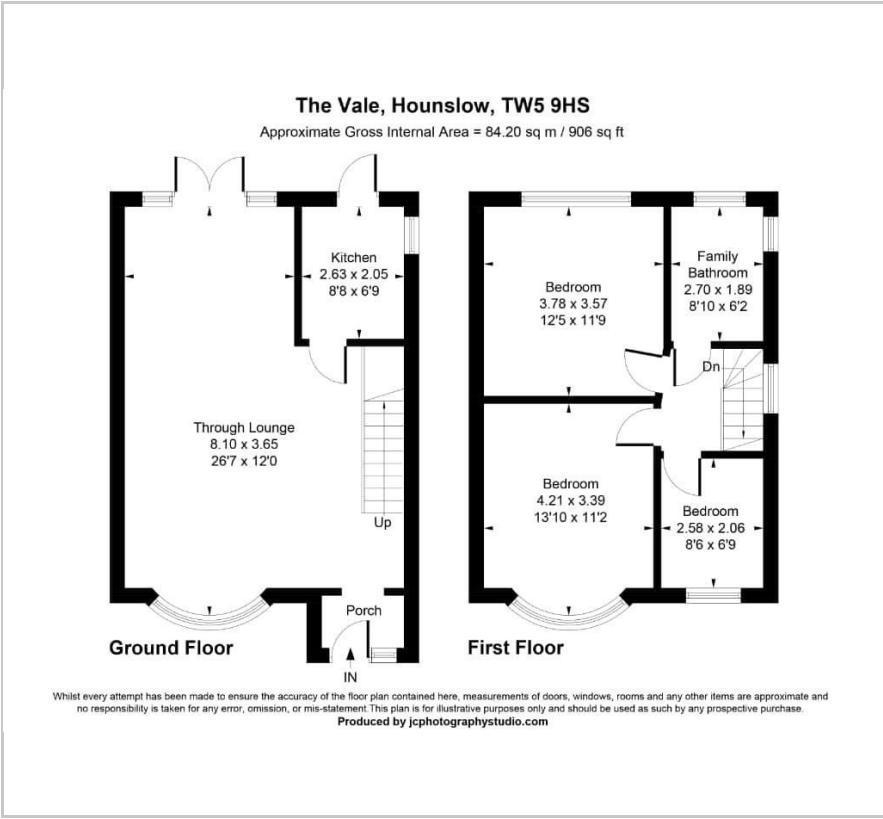

Area Map



Energy Efficiency Graph

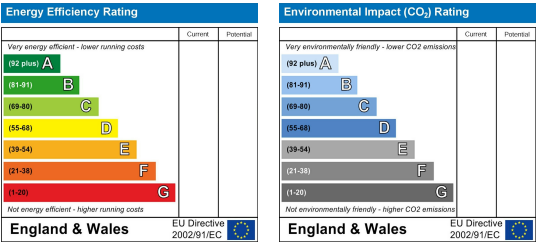

Viewing

Please contact our Move Inn Estates - Sales Office on 0208 574 4966 if you wish to arrange a viewing appointment for this property or require further information.

- Sought After Location
- Scope for Development (stpp)
- Three Bedrooms
- Chic Kitchen
- Lengthy Rear Garden
- Modernised + Well Presented Semi-Detached Home
- Side Gated Access
- Through Lounge
- Fashionable Family Bathroom Suite
- Front Garden with Off Street Parking



This charming property on The Vale offers a fantastic opportunity for families and investors looking for a well-connected home in Hounslow. Ideally located close to local shops, schools, and transport links, including Hounslow Central and Hounslow East Underground Stations, the property combines convenience with modern living.

Inside, the home features a bright and spacious living area, a fitted kitchen, comfortable bedrooms, and a contemporary bathroom. Additional benefits include a private garden and off-street parking, making it perfect for family life or as a strong investment in a high-demand area.

With its central location, excellent amenities, and versatile living space, this property represents a superb opportunity to secure a desirable home in Hounslow.



These particulars, whilst believed to be accurate are set out as a general outline only for guidance and do not constitute any part of an offer or contract. Intending purchasers should not rely on them as statements of representation of fact, but must satisfy themselves by inspection or otherwise as to their accuracy. No person in this firm's employment has the authority to make or give any representation or warranty in respect of the property.